



# TRIM TABS HATCH LIFTERS ACCESSORIES



*Proven Durability. Unmatched Boater Satisfaction.*

## Proven Durability Unmatched Boater Satisfaction

Boaters and boat builders alike know that our hydraulic systems are **built to last, easy to install** and proven to offer years of **maintenance-free service**. In addition to enjoying the **most reliable** system on the market, Bennett customers consistently rate Bennett's **legendary service** as the best they have ever experienced. And with **worldwide distribution and support**, Bennett products are easy to purchase and service.

### Customers Come First

*"We only work for one person... the boat owner."*

— Charles Bennett (1961)  
Inventor of the modern trim tab



### Experience the Bennett Advantage

More than **47 years** after Bennett introduced **the first adjustable trim tab**... & after more than **1 million trim tabs** produced... our customers are still the most worry-free people on the water.

*"With our dad's help we started a complete redesign and rebuild of a 1973 Seabird. The motor, deck, transom, steering, instrumentation... everything was replaced. Except for one, the original Bennett Trim Tabs."*

— Cameron Bradbeer and Chris Bradbeer  
Reddington Beach, FL



*"No one makes a product this durable or stands behind their customers like Bennett."*

— Captain Ron Green  
Islamorada, FL



*"The only time I ever had to replace my Bennett Trim Tabs is when I bought a new boat."*

— Steve Vassallo  
Foxboro, MA



*"Once they're installed correctly, you never have to think about them."*

— Michael Cote,  
Parts Department Manager  
Norwest Marine, Norwalk, CT



### Reputation for Reliability

**Responsive:** Instantaneous and accurate, no other system beats Bennett Trim Tabs.

**Precise:** Bennett Trim Tabs never over-run or free-wheel after you release the controls. Our hydraulic system allows exact adjustments, especially critical at high speeds.

**Maintenance-Free:** Install it and forget it. Our system offers years of trouble-free service.

**Durable:** Bennett Trim Tabs are designed to last longer than your boat. Third-party research and countless testimonials have proven this again and again.

### Superior by Design: The Power of Hydraulics

From jet fighters to automotive braking, hydraulic power is the preferred technology in demanding applications. When ever performance, responsiveness and reliability are called for, Bennett's system delivers. Bennett also offers more custom configurations than any other manufacturer.

### Bennett's SecurEnvelope™ Design features:

- No hoses or wires exposed to the elements
- No electric motors underwater to cause premature failure
- Hydraulic pump housed inside the boat in a secure, dry environment
- Unique, non-welded, interlocking hinge that is more resistant to corrosion than spot-welded piano hinges

# Enjoy The Ride Like You Never Have Before Every Time You Go Out, For Years To Come

*We know boaters are passionate about their boats.  
What drives us is helping them get the most out  
of their boating experience.*



## Bennett Benefits

### Performance

- Increase Speed
- Reduce Pounding
- Correct for Listing
- Eliminate Porpoising
- Offset Prop Torque

*Turn a teeth-jarring experience into a more comfortable ride.*

### Efficiency

- Reduce Fuel Consumption
- Reduce Engine Laboring
- Eliminate Squatting

*Bennett Trim Tabs are one of the few boat accessories that can pay for themselves.*

### Safety

- Improve Visibility
- Reduce Wake
- Improve Handling
- Reduce Hull Stress

*Relax at the wheel thanks to greater control over your bow high position.*

## How Trim Tabs Work

**Bennett Trim Tabs** are two independent, stainless steel, adjustable after-planes attached to the bottom edge of the transom. They are designed to improve lift and stability, greatly enhancing the boating experience. When the helm control is pressed, the trim tabs move into position. Water force on the trim tab surface creates upward pressure, raising the stern and lowering the bow.

The principle is simple. The results are impressive.

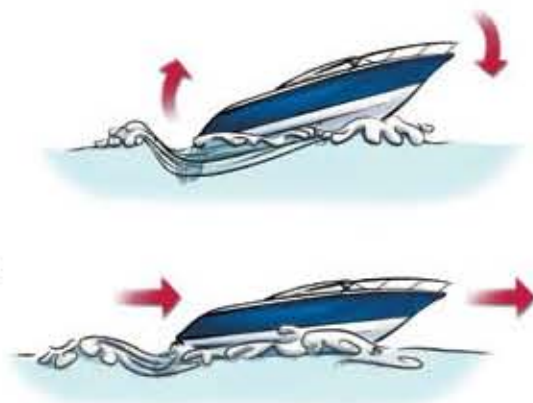

## Trim Tab Kits

*It's Easy To Find The Perfect Fit*

The right match between trim tab and boat is critical to achieve maximum performance. **Trim tabs** can be a **boat designer's ally** — if they fit the specifications of the boat. **Bennett works with builders, engineers and designers** to develop a trim tab system that allows the boat to operate as intended over a broader range of conditions.

### Modified Stainless Steel Trim Planes

Bennett Trim Tabs are made of high-quality 304 stainless steel and remain strong and rigid, even in the most challenging situations. The metal's advantage is that it can be sheared and bent to create a variety of shapes and levels of strength. Boat builders can have a custom tab built to their specifications without long manufacturing lead times.

### Special Configurations

Transoms come in all shapes and sizes, and space is often limited. Fortunately Bennett has solutions for design challenges like molded steps, integral swim platforms, exhaust outlet placement, stepped stern profiles, multiple deadrise angles at the transom, propeller tunnels and sophisticated pocket designs.

### Actuator Installation Flexibility

Bennett actuators are strong but flexible nylon/fiberglass hydraulic cylinders that push tabs into position. They allow for more variations in stroke than any trim tab system in the market — fitting almost any space a boat builder can design. Fluid flow through a concealed hole in the upper hinge at the top of the actuator, thus eliminating external hoses subject to damage.

### General Sizing Guidelines

Many factors affect the choice of properly sized trim tabs, and the ultimate responsibility for selection is up to the boat owner. Selection may vary based on power, engine configuration, weight distribution, type of boat, and use.

Boat Length	Engine Configuration	Trim Tab Size (span x chord)
15-19 (4.5-5.8 m)	Single I/O, Single Outboard or Inboard	12" x 9" (30 x 23 cm)
17-19 (5.2-5.8 m)	Single Outboard	8" x 10" (20 x 25 cm) M80
19-24 (5.8-7.3 m)	Single I/O, Single Outboard, or Inboard	18" x 9" (46 x 23 cm)
19-24 (5.8-7.3 m)	Limited Transom Space or Extra Lift	12" x 12" (30 x 30 cm)
20-23 (6.0-7.0 m)	Single I/O or Single Outboard	10" x 12" (25 x 30 cm) M120
22-27 (6.7-8.3 m)	Single I/O or Single Outboard	24" x 9" (61 x 23 cm)
22-27 (6.7-8.3 m)	Twin I/O or Twin Outboard	18" x 12" (46 x 30 cm)
25-30 (7.6-9.1 m)	Single I/O or Outboard	30" x 9" (76 x 23 cm)
25-30 (7.6-9.1 m)	Limited Transom Space or Extra Lift	30" x 12" (76 x 30 cm)
25-30 (7.6-9.1 m)	Twin I/O or Twin Outboard	24" x 12" (61 x 30 cm)
28-34 (8.5-10.4 m)	Inboard	36" x 9" (91 x 23 cm)
28-34 (8.5-10.4 m)	Limited Transom Space or Extra Lift	36" x 12" (91 x 30 cm)
28-34 (8.5-10.4 m)	Twin I/O or Twin Outboard	24" x 12" (61 x 30 cm)
32-38 (9.7-11.6 m)	Inboard	42" x 9" (107 x 23 cm)
32-38 (9.7-11.6 m)	Limited Transom Space or Extra Lift	42" x 12" (107 x 30 cm)
36-44 (11.0-13.4 m)	Inboard	48" x 9" (122 x 23 cm)
36-44 (11.0-13.4 m)	Limited Transom Space or Extra Lift	48" x 12" (122 x 30 cm)
42-50 (12.8-15.2 m)	Inboard	54" x 9" (137 x 23 cm)
50-60 (15.2-18.3 m)	Inboard	54" x 12" (137 x 30 cm)
60-65 (18.3-19.8 m)	Inboard	60" x 12" (153 x 30 cm)
65-70 (19.8-21.3 m)	Inboard	66" x 12" (168 x 30 cm)
70-80 (21.3-24.4 m)	Inboard	72" x 12" (183 x 30 cm)

Span = side to side measurement

Chord = fore to aft measurement

## Trim Plane Variations

Many factors affect the choice of properly sized trim tabs, and the ultimate responsibility for selection is up to the boat owner. Selection may vary based on power, engine configuration, weight distribution, type of boat, and use. The greater the surface area, angle of deflection and/or speed of the water flowing under the trim tab, the greater the lift.

To achieve maximum performance on your boat, Bennett offers more options than any other trim tab manufacturer. Since we are the manufacturer, we can customize trim plane assemblies based on your needs. Below are a few of our standard options. Check for availability and pricing. All sizes and variations are not shown below.



### Standard Trim Tab

A standard Trim Plane Assembly (TPA) includes a trim plane, backing plate and hinge. A standard kit includes two TPAs, two actuators, a hydraulic power unit, and all necessary wiring, tubing and hardware. Installation is transom mount. Available in 9' and 12' chord lengths.



### Bottom Mount

This installation is only used when the transom mount is not practical. It requires a flat bottom with no strakes or other protrusions. Often used for pocketed tabs.

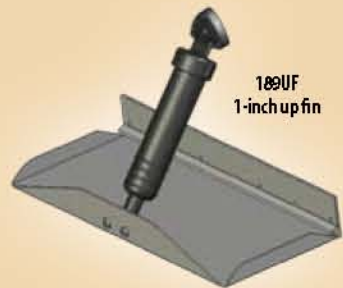

### Up Fins

An up fin is the upward bending of a trim plane's inboard and/or outboard edges. This engineering adds strength to the system by increasing the stiffness of the trim plane.



### Drop Fins

A drop fin is the downward bending of a trim plane's inboard and/or outboard edges. Maximizes lift on longer chord trim planes — captures water pressure that would normally escape out the sides of the tabs and channels it aft.

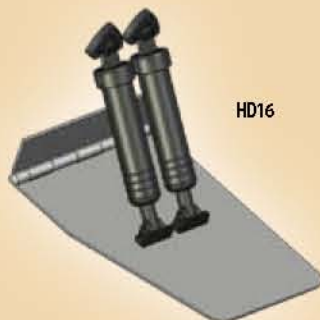

### Dual Actuator, Heavy Gauge

The HD series features heavy duty, 10-gauge stainless steel tabs, secured with a massive piano hinge. The tab is cut at an angle on one side to accommodate limited transom space from multiple outboards. Dual actuators on each tab absorb shock during high speed impact with the water.

## Meet Your Match

### No One Has More Options To Suit Your Needs

#### Actuator Installation Options

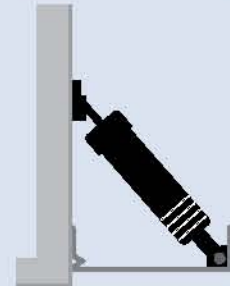

Standard Installation

Upper hinge of actuator positioned against the transom.

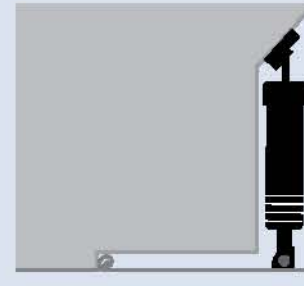

Vertical Installation

Though trim tabs are most effective when extended aft from the transom, pockets present an integrated appearance and can easily accommodate Bennett Trim Tabs. The trim planes can be bottom mounted (see Vertical, above left), or standard mounted (see Reverse, above right) and the actuator repositioned to fit into the recesses in the hull. This is a popular installation for sport fishing, as the tabs won't get in the way of fishing lines and fish brought to the transom for boarding.

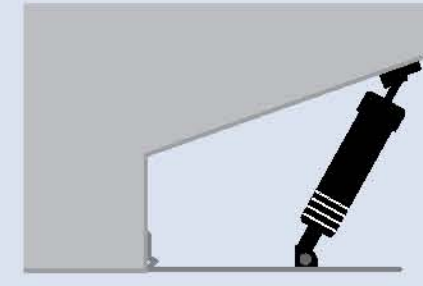

Reverse Installation

#### Actuator Flexible Upper Hinge



#### Actuator Variations



A1101A – Standard Length

#### Standard Actuator

As shown, retracted length is 13 3/4" with a standard stroke of 2 1/2". Stroke can be modified to meet unique specifications.



A1200S – Standard Length

#### Short Actuator

An alternative to the Standard Actuator, for installations where space is limited. Retracted length is 11 3/4" with a standard stroke of 2 1/2". Stroke can also be modified.



A1101EX – External Line

#### External Line Actuator

Used in cases of total inaccessibility inside the transom. Unlike the Standard Actuator, the external line hydraulics enter the transom by means of external tubing above the waterline.



## SST System – The Ultimate in Brawn & Beauty

A comprehensive trimming system that meets the demands of the 50-foot (16-meter) to 150-foot (46-meter) large yacht market. Also available for sport fishing, commercial and military applications.

#### Each SST System includes:

- Single or dual 304 stainless steel actuators, single or dual acting (with no external lines)
- 7-gauge, 304 stainless steel, heavy duty trim planes, with an exclusive interlocking 10-gauge hinge
- Two high-pressure, compact hydraulic power units, either single acting or dual acting pumps
- Choice of three indication systems, all with internal sensors
- Auto Tab Retractor
- Euro-Style Rocker Switch Control (ES2000)

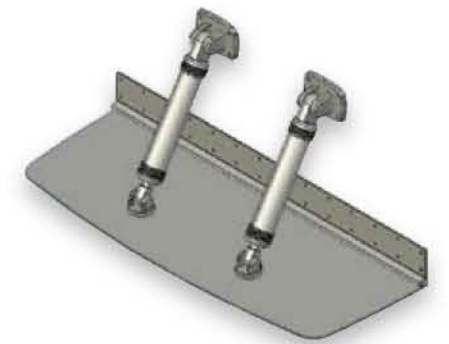

**SST**  
SYSTEM BY BENNETT

# Hydraulic Power Unit

## Big Strength In A Small & Secure Package

Bennett's Hydraulic Power Unit (HPU) is a compact powerhouse that drives the whole trim tab operation. Protected inside the boat in a secure, dry environment, it's built to last with the strength to lower and hold even the largest tabs in place.

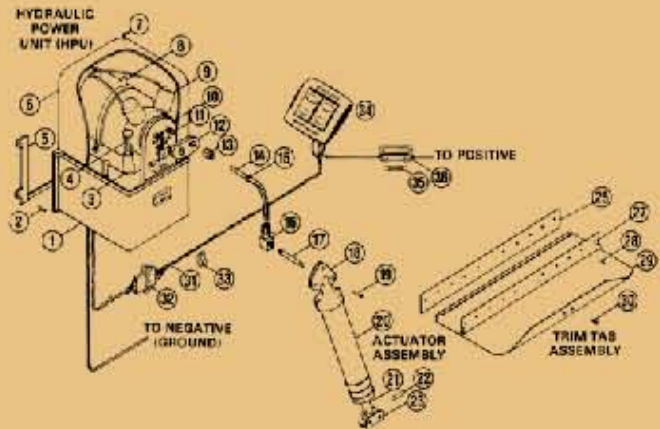

Diagram#	Description	Part#
1	Fluid Reservoir	VP139
2	#10x 1" Screw	H1180
3	Filter Stack	
4	Filter Plug	VP1140
5	Mounting Bracket for HPU	H1179
6	Lexan Cover	VP138
7	Type 25 Thread Cutting Screw	VP154
8	Motor Strap	VP1142
9	Solenoid Valve	VP1135-R (red) VP1135-G (green)
10	Faceplate for HPU	VP1144
11	1/8" Pipe to 1/4" Tube Connector	VP1146
12	Hex Retainer	VP1141
13	Nut with Ferrule	T1107
14	Hydraulic Tubing (20' unless otherwise specified)	T110520
15	Tube Bending Clip	H1103
16	Female Elbow	H1102
17	Pipe Nipple (3" unless otherwise specified)	H11013
18	Upper Hinge	A1103
19	#14x 1-1/2" Screw	H1104
20	Cylinder Body	A1105
21	Piston with O-Ring	A1109
22	Lower Hinge Pin	A1115
23	Lower Hinge	A1113
25	Banding Plate	varies with size
27	Hinge Plate	varies with size
28	#10x 1-1/4" Screw	EHT071
29	Trim Tab Only	varies with size
30	1/4" - 20 x 3/4" Machine Screw	H1105
31	Wire Harness (22' unless otherwise specified)	WH1000
32	Quick-Disconnect Plug	VP1143
33	Nylon Hanger	H1177
34	Euro-Style Rocker Switch Control	ES2000
35	20 Amp Fuse (12 vdc system)	H1176
36	Fuse Holder	H1178

### How It Works

The HPU creates hydraulic pressure to lower and raise the trim tabs. It employs two solenoid valves to direct the flow of an automatic transmission fluid to the actuators. These solenoid valves lock tightly to secure the tabs in place. A Lexan cover protects the electro-hydraulic unit from the occasional wash down and a translucent reservoir allows fluid check at a glance.

Installs easily with a sturdy vertical mounting bracket. Standard Transom Mount shown.

Measures 4" x 7 1/2" x 5 1/2".  
Uses automatic transmission fluid.  
Includes pump, solenoid valves,  
reservoir and cover.



**V3 51HPU1 – Hydraulic Power Unit – 12 Volt**

**V3 51HPU2 – Hydraulic Power Unit – 24 Volt**

### Additional Mounting Options



**Floor Mount** – for flat surfaces



**Wedge** – for uneven transoms

### Euro-Style Rocker Switch Control

All our trim tab kits are available with this ergonomically designed, water resistant control that easily fits into a single 2 3/4-inch hole.

**ES2000**

**ES2000A – Second Station Control**

# Hatch Lifters

## Hydraulic Power, Quiet Operation

Using proven hydraulic technology, Bennett Hatch Lifter Systems raise hatches at the push of a button. The operation is quiet, smooth and responsive with no cylinder drift.



**Retrofit Hatch Lifting Systems** can be operated by the Trim Tab Hydraulic Power Unit. Kits are complete with all necessary hardware, tubing and fittings for simple Hatch Lifter installations. **Independent Systems** include the Trim Tab Hydraulic Power Unit. **Independent Dual Acting Systems** are also available for applications that need a return "pull and hold" feature.

### Hatch Lifter cylinder features:

- Single cylinder has about 250 lbs. of vertical lifting capability
- 3/4-inch diameter stainless steel shaft, inside a black anodized aluminum cylinder
- Standard stroke is 18 inches with 12- and 24-inch strokes also available
- Dual cylinder systems can move simultaneously or independently



### Multiple Systems Available For Multiple Applications



#### Single Acting

Using hydraulic force to extend, and hatch weight (gravity) to retract. It's also easy to add a Hatch Lifter since it can share the Hydraulic Power Unit with the Trim Tabs.



#### Dual Acting

Ideal for opening a sliding cabin door, windshield, a hatch that bounces underway, or any application needing a return "pull and hold" feature.

## Indicators

### 3 Ways To Keep Tabs On Your Tabs

In addition to a smoother ride, Bennett offers boaters more precise control with three indication options.



EIC5000

#### Electronic Indicator Control (EIC)

Three features combined into one sophisticated control — the popular Bennett rocker switch control, trim tab indicator and the Auto Tab Retractor. Water resistant, highly accurate and features variable intensity LEDs for night or day. Features a relay module mounted near the transom, which simplifies installation by reducing the number of wires to run to the helm.

**EIC5000 – EIC Kit – 12 Volt**

**EIC5000A – Dual Station EIC Kit – 12 Volt**

**EIC50002 – EIC Kit – 24 Volt**

**EIC5000A2 – Dual Station EIC Kit – 24 Volt**

#### Tab Position Indicator (TPI)

Attractive, compact, water resistant and easy to install. The TPI helm display accurately shows deflection percentage of each trim tab, and the LED brightness is adjustable for any lighting condition. Works with all Bennett Trim Tabs.

**TPI2000 – TPI Kit – 12 Volt and 24 Volt**

**TPI2000B – Dual Station TPI Kit – 12 Volt and 24 Volt**



Tab Position Indicator

TPI2000



#### NMEA 2000 Indicator Kit

Compatible with NMEA 2000® compliant electronics. See the position of your trim tabs on your NMEA 2000 compatible multi-function display or gauge, GPS/chartplotter or sonar. The kit comes with Bennett Trim Tab sensors, interface module and NMEA compliant connectors. *Gauge shown not included.*

**NMEA1**

## Innovative Accessories

### Making Life Easier For The Boater



The original ATC won the coveted **Innovation of the Year Award** from the National Marine Manufacturer's Association, the largest marine industry association in the United States. The new version of the ATC, the AC3000, offers the same benefits in a more compact installation. It incorporates new technology that allows it to be smaller with fewer components.

#### Auto Tab Control (ATC)

Bennett Marine pioneered the Auto Tab Control to make the boater's experience on the water even better. It does exactly what it says it does — interacting directly with your trim tab system to automatically monitor your boat's position and maintain the perfect cruising attitude. Calculating more than a thousand attitude readings per second, the ATC adjusts your trim tabs to changes in vessel speed, sea conditions and shifting weight.

#### Benefits For The Boater

- **Saves you money on fuel**
- **Easy to install** — just plug and play!
- **No more guesswork** — it trims the boat better than you can
- **The most comfortable ride** you've ever had on your boat.

**AC3000 – ATC Kit**

**AC3000A – Dual Station ATC Kit**

#### Auto Tab Retractor (ATR)

With Bennett Marine's patented Auto Tab Retractor, trailered or dry storage boats have added defense from trim tab damage. Just turn off the ignition and tabs are automatically retracted to "full-up" during hauling, trailering and storage. Easily installed under the instrument panel, the ATR connects to the trim tab control and engine ignition switch.

**AR 512 – Auto Tab Retractor 12 Volt**

**AR 524 – Auto Tab Retractor 24 Volt**



#### Relay Module

A Relay Module reduces voltage drop in Trim Tab Systems with longer wire runs. With the older trim tab controls, RT1000 and RS1000, the Relay Module also functions as an Interrupter Relay and will prevent a fuse from blowing if Bow Down and Bow Up are inadvertently pressed at the same time.

**RM12 – Relay Module 12 Volt**

**RM24 – Relay Module 24 Volt**





**Bennett Marine, Inc.**  
550 Jim Moran Boulevard • Deerfield Beach, Florida 33442 • USA  
Phone: +1.954.427.1400 • Fax: +1.954.480.2897  
Web: [www.BennettTrimTabs.com](http://www.BennettTrimTabs.com)